

Shock Absorber: Service and Repair

COMPONENTS

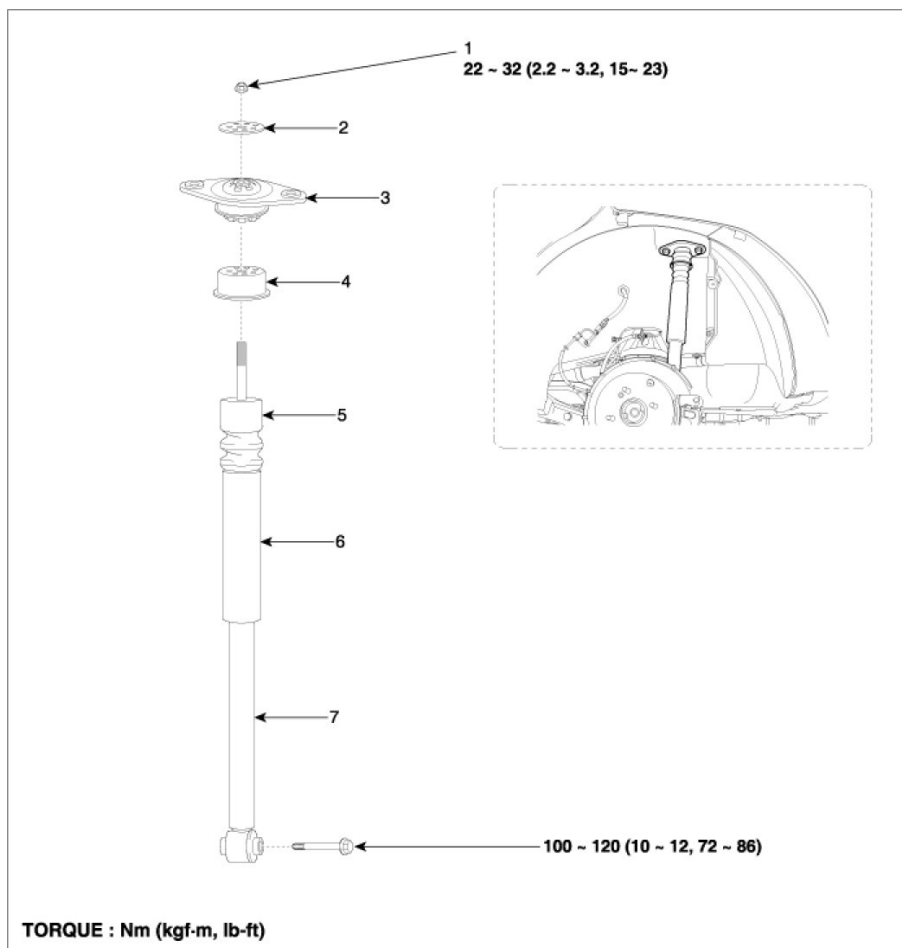

- 1. Self locking nut
- 2. Retainer
- 3. Insulator
- 4. Upper cup

- 5. Bumper stopper
- 6. Dust cover
- 7. Rear shock absorber assembly

REMOVAL

1. Remove the wheel and tire.

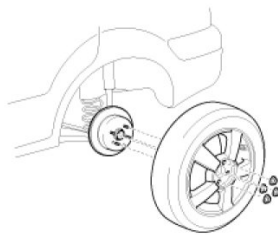

2. After supporting the rear torsion axle beam with a jack, remove the rear shock absorber lower mounting bolt. Remove the rear shock absorber.

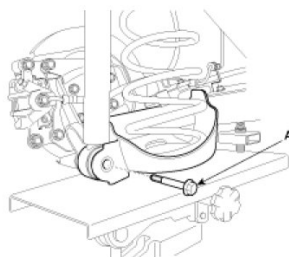

3. Remove the rear shock absorber mounting bolts(A).

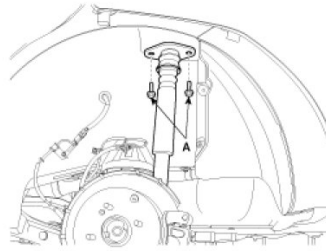

INSTALLATION

1. Tighten the rear shock absorber upper mounting bolt to the specified torque as follows.

Specified torque : 40 - 60 Nm (4 - 6 kgf-m, 28 - 43 lb-ft)

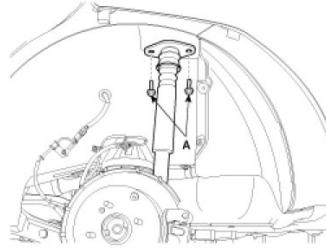

2. After placing a jack at the bottom of the rear torsion axle beam and jacking up the vehicle to the proper location, tighten the rear shock absorber lower mounting bolt(A).

Specified torque : 100 - 120 Nm (10 - 12 kgf-m, 72 - 86 lb-ft)

CAUTION:

Check that the rear coil spring is located in the proper position.

